

MEMORANDUM

To: All Interested Vendors

From: Theresa Kauffman-Bidwell
IT Vendor and Procurement
Administrator

Date: March 11, 2022

Subject: Addendum No. 2
RFP 22-015 Security Equipment Sourcing, Configuration, & Installation
Services
Gahanna Technology Site Plans

Part I.

RFP 22-015 Security Equipment Sourcing, Configuration, & Installation Services site plans have been added.

Bids are due by 12:00 PM, noon, on Tuesday, March 30, 2022 to procurement@columbuslibrary.org.

BIDDERS ARE REQUIRED TO ACKNOWLEDGE THE RECEIPT OF THIS MEMORANDUM (ADDENDUM NO. 2) ON THE ACKNOWLEDGEMENT OF ADDENDA FORM IN THE RFP DOCUMENTS

TECHNOLOGY SYSTEMS ABBREVIATIONS table listing various acronyms and their corresponding full names, such as ANSI, AP, ATM, AVGS, BAS, BCT, BICSI, BMS, CAD, CAN, CATV, CCTV, CM, CMP, CMR, COAX, CPC, CPE, CPU, CSI, CT, DAS, DB, dBmV, EF, EIA, ER, FCC, FDDI, Gb, GC, HC, HH, HVAC, IC, ID, IDC, IEEE, IG, I/O, IP, IT, KVM, LAN, MATV, Mb, Mb/s, MC, MD, MDF, MH, MM, MPOF, MSDS, MUTOA, NA, NEC, NIC, OD, OEM, OFCR, OFNP, OFNR, OSP, OTR, PA, PBX, PM, P/E, PSTN, PTZ, P/V, QoS, RCD, RF, RFI, RGB, RJ, SAN, SCS, S/TP, SFF, SM, STP, SVGA, TBB, TC, TDD, TDM, TSB, TIA, TMGB, TR, TV, TV, UBC, UL, UPS, USOC, UTP, VSP, WAN, WAF, WLAN.

- TECHNOLOGY GENERAL NOTES
- 1. DO NOT SCALE DRAWINGS. VERIFY DIMENSIONS IN FIELD PRIOR TO COMMENCEMENT OF WORK.
 - 2. WHEREVER THE WORD PROVIDE IS USED IT SHALL MEAN TO "FURNISH AND INSTALL".
 - 3. IT IS THE INTENT OF THESE DRAWINGS AND SPECIFICATIONS TO ESTABLISH A STANDARD OF QUALITY. THE OWNER RESERVES THE RIGHT TO APPROVE METHODS AND MATERIALS NOT REFLECTED HERE IN.
 - 4. CONTRACTOR SHALL VISIT SITE PRIOR TO BID AND VERIFY THAT CONDITIONS ARE AS INDICATED. CONTRACTOR SHALL INCLUDE IN THIS BID COSTS REQUIRED TO MAKE HIS WORK MEET EXISTING CONDITIONS.
 - 5. WORK SHALL BE PERFORMED IN A WORKMANLIKE MANNER TO THE SATISFACTION OF THE OWNER.
 - 6. WORK, MATERIALS, AND EQUIPMENT SHALL CONFORM TO THE LATEST EDITIONS OF LOCAL, STATE, AND NATIONAL CODES, ORDINANCES AND STANDARDS.
 - 7. PROVIDE AS-BUILT DRAWINGS. INCLUDE ALL ADDENDUM ITEMS, CHANGE ORDERS, ALTERATIONS, REROUTINGS, ETC.
 - 8. VERIFY EXACT LOCATION OF EQUIPMENT PRIOR TO ROUGH-IN.
 - 9. ALL CABLING THAT PASSES THROUGH OR ORIGINATES IN EXPOSED CEILING SPACES SHALL BE INSTALLED IN LISTED METALLIC RACEWAYS. RACEWAYS IN SLAB ON-GRADE OR BELOW GRADE SHALL BE SCHEDULE 40 P.V.C. TRANSITIONS FROM BELOW TO ABOVE GRADE SHALL BE WITH RIGID STEEL ELBOWS. EMT FITTINGS SHALL BE MALLEABLE IRON OR STEEL CONNECTORS SHALL BE INSULATED THROAT TYPE.
 - 10. CONDUITS LARGER THAN 1" SHALL HAVE LONG RADIUS SWEEPS (12 TIMES THE DIAMETER).
 - 11. THERE SHALL BE NO MORE THAN TWO 90 DEGREE BENDS BETWEEN PULL BOXES. PULL BOXES AND CABLE TRAYS SHOWN ON DRAWINGS SHALL BE CONSIDERED THE MINIMUM REQUIREMENTS. CONTRACTOR SHALL INSTALL PULL BOXES ACCORDING TO FIELD CONDITIONS.
 - 12. ALL CABLING ABOVE ACCESSIBLE CEILING AREAS, WHERE NOT IN CABLE TRAY, SHALL BE SUPPORTED WITH A J-HOOK SUPPORT SYSTEM EVERY 4' ON CENTER. J-HOOK SHALL NOT BE SUPPORTED BY OR OTHERWISE ATTACHED TO THE SUSPENDED CEILING GRID WIRES OR ANY OTHER BUILDING ANCILLARY SYSTEM SUCH AS ELECTRICAL OR PLUMBING CONDUTS.
 - 13. REFER TO ARCHITECTURAL PLANS FOR WALL CONSTRUCTION.
 - 14. ALL CONDUITS IN AREAS WITHOUT SUSPENDED CEILINGS SHALL BE RUN AS INCONSPICUOUSLY AS POSSIBLE. HIDDEN BEHIND BEAMS, CLOSE TO DECK, ETC. OBTAIN APPROVAL OF CONDUIT RUNS BELOW BEAMS WITH OWNERS REPRESENTATIVE.
 - 15. RACEWAYS SHALL BE RUN AS INCONSPICUOUSLY AS POSSIBLE. VERTICAL RUNS SHALL OCCUR IN CORNERS OF ROOMS. HORIZONTAL RUNS SHALL OCCUR ALONG BASEBOARD OF WALL WITH VERTICAL RUNS UP TO THE DEVICE BOXES BRANCHING OUT OF CORNER BOXES, TEES OR ELBOWS.
 - 16. ADD STEEL BRIDGING BETWEEN PURLINS/JOISTS/BEAMS AS NECESSARY TO SUPPORT THE WEIGHT OF SUSPENDED DEVICES AND FIXTURES.
 - 17. ALL DEVICES IN CEILINGS IN A ROOM SHALL BE ALIGNED.
 - 18. AT EXISTING LOCATION WHERE WALL FURRING DEPTH IS TOO SHALLOW FOR A STANDARD DEPTH JUNCTION BOX, CONTRACTOR SHALL CHISEL OUT SURROUNDING MATERIAL SO THAT BOX IS FLUSH WITH WALL. WHERE CONDUIT IS TOO DEEP, CONTRACTOR SHALL CHANNEL OUT SURROUNDING MATERIAL. EXPOSED SURFACE MOUNTED CONDUIT AND JUNCTION BOXES ARE PROHIBITED.
 - 19. REFER TO ALL SITE PLANS FOR SITE REQUIREMENTS.
 - 20. PROVIDE SURFACE RACEWAY SIZE ADEQUATE FOR QUANTITY OF DATA CABLES.
 - 21. COORDINATE WITH OWNER FOR EXACT MOUNTING HEIGHT AND LOCATION OF ALL WALL-MOUNTED SECURITY CAMERAS.

TECHNOLOGY SHEET INDEX

SHEET NUMBER	SHEET NAME
T-000	TECHNOLOGY SYMBOLS AND LEGENDS
T-201	TECHNOLOGY SITE PLAN
T-201	LEVEL 01 TECHNOLOGY PLAN
T-203	LEVEL 02 TECHNOLOGY PLAN
T-401	TECHNOLOGY ENLARGED PLANS
T-701	TECHNOLOGY DETAILS
T-702	TECHNOLOGY DETAILS
T-703	TECHNOLOGY DETAILS
T-704	TECHNOLOGY DETAILS

TECHNOLOGY SYMBOLS

1. SOME SYMBOLS MAY NOT BE USED.
2. MOUNTING HEIGHTS ARE TO TOP U.N.O.

SYMBOL	DESCRIPTION	MOUNTING HEIGHT UNLESS NOTED OTHERWISE
AUDIO/VISUAL SYMBOLS		
AV	ROUGH IN FOR AUDIO/VISUAL OUTLET. PROVIDE 4-11/16" DEEP BOX W/ DOUBLE GANG RING AND (2) 1-1/4" CONDUITS STUBBED TO ABOVE ACCESSIBLE CEILING FOR LAY-IN CEILING APPLICATIONS (CONDUITS EXTENDED TO PROJECTOR FOR EXPOSED CEILING APPLICATIONS).	20"
AV	MULTIMEDIA INPUT/OUTPUT PLATE	---
DM	CRESTRON QM-WMC-MIC-OUTLET	---
TS	CRESTRON TOUCHSCREEN CONTROLLER	---
H - H	HORN TYPE SPEAKER, CEILING MOUNTED; WALL MOUNTED	94"
SP	SOUND SYSTEM SPEAKER PENDANT MOUNTED	---
S v	SOUND SYSTEM SPEAKER WITH INTEGRAL VOLUME CONTROL	---
S - S	SOUND SYSTEM SPEAKER, CEILING MOUNTED; WALL MOUNTED	94"
SP	SOUND SYSTEM SPEAKER ZONE PENDANT MOUNTED * = ZONE NUMBER	---
CP	VOLUME CONTROLLER	---
S - S	SOUND SYSTEM SPEAKER ZONE, CEILING MOUNTED; WALL MOUNTED * = ZONE NUMBER	94"
S X	SOUND SYSTEM OUTDOOR HORN SPEAKER	---
SPWR	GYMNASIUM SPEAKERS. MOUNT ON STRUCTURAL BEAMS AND AM AT CENTER ROW OF SEATS.	---
V	SOUND SYSTEM VOLUME ATTENUATOR	48"
P	PROJECTOR, CEILING MOUNTED.	---
TV	VIDEO MONITOR OUTLET	---
AV	AUDIO/VISUAL OUTLET. PROVIDE 4-11/16" DEEP BOX W/ DOUBLE GANG RING AND (2) 1-1/4" CONDUITS STUBBED TO ABOVE ACCESSIBLE CEILING FOR LAY-IN CEILING APPLICATIONS (CONDUITS EXTENDED TO PROJECTOR FOR EXPOSED CEILING APPLICATIONS). L = LOW OUTLET	SEE DRAWINGS
BT	BLUETOOTH AUDIO RECEIVER	48"
⊕ : ⊕	MICROPHONE OUTLET, WALL MOUNTED; FLOOR MOUNTED	20"
AUDIO/VISUAL IS NOT IN CONTRACT FOR THIS BID. SYMBOLS FOR REFERENCE ONLY		
SECURITY SYMBOLS		
□	PUSHBUTTON STATION	48"
C	INTERIOR SECURITY SYSTEM CAMERA EXTERIOR SECURITY SYSTEM CAMERA, "PTZ" = PAN, TILT, ZOOM	CEILING 144"
CR	SECURITY SYSTEM CARD READER	48"
M C S	INTERCOM: MASTER, SLAVE STATION	48"
K	SECURITY SYSTEM KEY PAD	48"
MD	SECURITY SYSTEM MOTION DETECTOR	CEILING
P	SECURITY SYSTEM DOOR POSITION SWITCH	---
GB	SECURITY SYSTEM GLASS BREAK DETECTION	CEILING
□	PUSHBUTTON STATION	---
VOICE/DATA SYMBOLS		
AF	WIRELESS ACCESS POINT, (2) CAT6 UTP	CEILING
▼ 1	1 PORT, WALL MOUNT, (1) CAT6 UTP	20"
▼ 2	2 PORT, WALL MOUNT, (2) CAT6 UTP	20"
▼ 3	3 PORT, WALL MOUNT, (3) CAT6 UTP	20"
▼ 4	4 PORT, WALL MOUNT, (4) CAT6 UTP	20"
▼ C	CEILING MOUNT * = # OF CAT6 PORTS (AND CABLES)	20"
▼ W	WALL MOUNT, (1) CAT6 UTP	48"
TV	TELEVISION OUTLET, (1) CAT6 UTP, (1) R6G COAX	60"
VOICE/DATA IS NOT IN CONTRACT FOR THIS BID. SYMBOLS FOR REFERENCE ONLY		

REFER TO DETAIL SHEETS FOR MORE INFORMATION

CAMERA SCHEDULE

NUMBER	TYPE	MOUNTING	ENVIRONMENT	DESCRIPTION	SHEET
01	#11 OUTDOOR 360	WALL-MOUNTED VERTICALLY AT 12'	EXTERIOR	SW CORNER	T-201
02	#11 OUTDOOR 360	WALL-MOUNTED VERTICALLY AT 12'	EXTERIOR	WEST WALL	T-201
03	#7 2MP OUTDOOR BULLET	WALL-MOUNTED VERTICALLY AT 12'	EXTERIOR	VESTIBULE	T-201
04	#11 OUTDOOR 360	WALL-MOUNTED VERTICALLY AT 12'	EXTERIOR	WEST WALL	T-201
05	#11 OUTDOOR 360	WALL-MOUNTED VERTICALLY AT 12'	EXTERIOR	NW CORNER	T-201
06	#7 2MP OUTDOOR BULLET	WALL-MOUNTED VERTICALLY AT 12'	EXTERIOR	NORTH WALL	T-201
07	#11 OUTDOOR 360	WALL-MOUNTED VERTICALLY AT 12'	EXTERIOR	NE CORNER SMALL MEETING	T-201
08	#11 OUTDOOR 360	WALL-MOUNTED VERTICALLY AT 12'	EXTERIOR	NE CORNER PROGRAM SPACE	T-201
09	#11 OUTDOOR 360	WALL-MOUNTED VERTICALLY AT 12'	EXTERIOR	SE CORNER PROGRAM SPACE	T-201
10	#11 OUTDOOR 360	WALL-MOUNTED VERTICALLY AT 12'	EXTERIOR	SE CORNER TWEEN ZONE	T-201
11	#8 360-DEGREE FISHEYE	CEILING-MOUNTED	INTERIOR	WELCOME ZONE	T-201
12	#4 2MP VARIFOCAL INDOOR DOME	CEILING-MOUNTED	INTERIOR	SEATING AREA	T-201
13	#4 2MP VARIFOCAL INDOOR DOME	CEILING-MOUNTED	INTERIOR	CUST SERVICE DESK	T-201
14	#4 2MP VARIFOCAL INDOOR DOME	WALL-MOUNTED VERTICALLY AT 7' 8" AFG	INTERIOR	RESTROOM CORRIDOR	T-201
15	#4 2MP VARIFOCAL INDOOR DOME	CEILING-MOUNTED	INTERIOR	HOMEWORK HELP	T-201
16	#4 2MP VARIFOCAL INDOOR DOME	CEILING-MOUNTED	INTERIOR	TWEEN ZONE	T-201
17	#4 2MP VARIFOCAL INDOOR DOME	CEILING-MOUNTED	INTERIOR	TWEEN ZONE	T-201
18	#4 2MP VARIFOCAL INDOOR DOME	WALL-MOUNTED VERTICALLY AT 7' 8" AFG	INTERIOR	STAIR 1	T-201
19	#4 2MP VARIFOCAL INDOOR DOME	WALL-MOUNTED VERTICALLY AT 7' 8" AFG	INTERIOR	ELEVATORS	T-201
20	#4 2MP VARIFOCAL INDOOR DOME	WALL-MOUNTED VERTICALLY AT 7' 8" AFG	INTERIOR	WELCOME ZONE	T-201
21	#4 2MP VARIFOCAL INDOOR DOME	WALL-MOUNTED VERTICALLY AT 7' 8" AFG	INTERIOR	ELEVATOR LOBBY	T-201
22	#4 2MP VARIFOCAL INDOOR DOME	CEILING-MOUNTED	INTERIOR	LARGE MEETING	T-201
23	#4 2MP VARIFOCAL INDOOR DOME	CEILING-MOUNTED	INTERIOR	KIDS ZONE CORRIDOR	T-201
24	#4 2MP VARIFOCAL INDOOR DOME	CEILING-MOUNTED	INTERIOR	SMALL MEETING	T-201
25	#4 2MP VARIFOCAL INDOOR DOME	CEILING-MOUNTED	INTERIOR	SMALL MEETING	T-201
26	#4 2MP VARIFOCAL INDOOR DOME	WALL-MOUNTED VERTICALLY AT 7' 8" AFG	INTERIOR	STAIR 3	T-201
27	#4 2MP VARIFOCAL INDOOR DOME	CEILING-MOUNTED	INTERIOR	PROGRAM SPACE	T-201
28	#4 2MP VARIFOCAL INDOOR DOME	CEILING-MOUNTED	INTERIOR	QUIET ZONE	T-202
29	#4 2MP VARIFOCAL INDOOR DOME	CEILING-MOUNTED	INTERIOR	QUIET ZONE	T-202
30	#4 2MP VARIFOCAL INDOOR DOME	WALL-MOUNTED VERTICALLY AT 7' 8" AFG	INTERIOR	STAIR 1	T-202
31	#4 2MP VARIFOCAL INDOOR DOME	CEILING-MOUNTED	INTERIOR	COMMODITY COMPUTING	T-202
32	#9 180-DEGREE CAMERA	WALL-MOUNTED VERTICALLY AT 7' 8" AFG	INTERIOR	PERIODICALS N WALL	T-202
33	#4 2MP VARIFOCAL INDOOR DOME	CEILING-MOUNTED	INTERIOR	STUDY RMS	T-202
34	#4 2MP VARIFOCAL INDOOR DOME	CEILING-MOUNTED	INTERIOR	STUDY RMS	T-202
35	#4 2MP VARIFOCAL INDOOR DOME	CEILING-MOUNTED	INTERIOR	TEEN ZONE	T-202
36	#4 2MP VARIFOCAL INDOOR DOME	CEILING-MOUNTED	INTERIOR	TEEN ZONE	T-202
37	#9 180-DEGREE CAMERA	WALL-MOUNTED VERTICALLY AT 7' 8" AFG	INTERIOR	COLLECTIONS N WALL	T-202
38	#4 2MP VARIFOCAL INDOOR DOME	WALL-MOUNTED VERTICALLY AT 7' 8" AFG	INTERIOR	STAIR 3	T-202
39	#4 2MP VARIFOCAL INDOOR DOME	WALL-MOUNTED VERTICALLY AT 7' 8" AFG	INTERIOR	E READING CHAIRS	T-202
40	#4 2MP VARIFOCAL INDOOR DOME	WALL-MOUNTED VERTICALLY AT 7' 8" AFG	INTERIOR	COLLECTIONS S WALL	T-202
41	#10 DUAL-SENSOR CAMERA	CEILING-MOUNTED	INTERIOR	MAIN STAIR	T-202
42	#9 180-DEGREE CAMERA	WALL-MOUNTED VERTICALLY AT 7' 8" AFG	INTERIOR	PERIODICALS S WALL	T-202
43	#4 2MP VARIFOCAL INDOOR DOME	WALL-MOUNTED VERTICALLY AT 7' 8" AFG	INTERIOR	W READING CHAIRS	T-202
44	#11 OUTDOOR 360	POLE-MOUNTED VERTICALLY AT 14'	EXTERIOR	PARKING LOT (REFER TO SITE PLAN)	T-001
45	#11 OUTDOOR 360	POLE-MOUNTED VERTICALLY AT 14'	EXTERIOR	PARKING LOT (REFER TO SITE PLAN)	T-001
46	#11 OUTDOOR 360	POLE-MOUNTED VERTICALLY AT 14'	EXTERIOR	PARKING LOT (REFER TO SITE PLAN)	T-001
47	#11 OUTDOOR 360	POLE-MOUNTED VERTICALLY AT 14'	EXTERIOR	PARKING LOT (REFER TO SITE PLAN)	T-001

COLUMBUS METROPOLITAN LIBRARY

CONSTRUCTION MANAGER: TURNER CONSTRUCTION COMPANY
282 HANOVER ST
COLUMBUS, OH 614-984-3000

STRUCTURAL ENGINEER: KORDA NEMETH ENGINEERING, INC
1650 WATERMARK DR. STE 200
COLUMBUS, OH 43215 614-467-1650

MECHANICAL ELECTRICAL: KORDA NEMETH ENGINEERING, INC
1650 WATERMARK DR. STE 200
COLUMBUS, OH 43215 614-467-1650

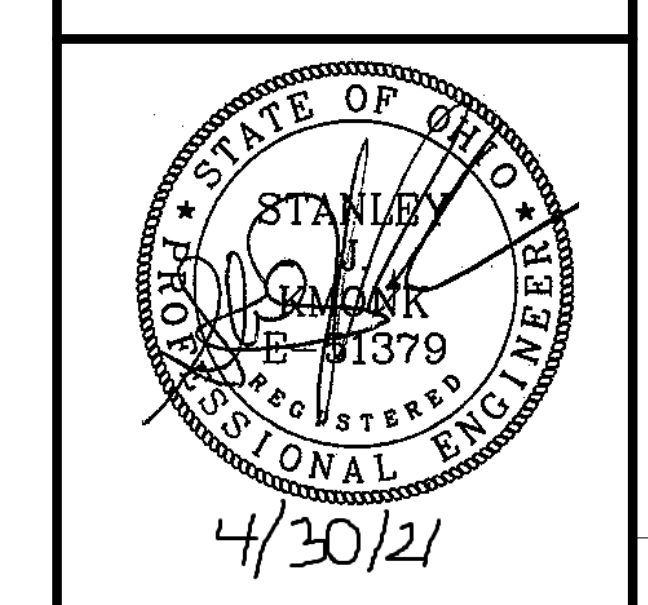

GAHANNA BRANCH LIBRARY

CONSTRUCTION DOCUMENTS

3/9/2022

REVISIONS table with columns: MARK, DATE, DESCRIPTION

SCALE: PROJECT ARCHITECT
KNE

PROJECT NUMBER: 102327

TECHNOLOGY SYMBOLS AND LEGENDS

SHEET NUMBER: T-000

KORDA NEMETH ENGINEERING
1650 WATERMARK DRIVE
SUITE 200
COLUMBUS, OHIO 43215

DRAWN BY: Garrett W. Strauss
DESIGNED BY: Paolo S. Galina
CHECKED BY: [blank]
PROJECT NUMBER: 2021-0529

PLAN NORTH

COLUMBUS METROPOLITAN LIBRARY

CONSTRUCTION MANAGER:
TURNER CONSTRUCTION COMPANY
282 HANOVER ST
COLUMBUS, OH 614-984-3000

STRUCTURAL ENGINEER:
KORDA NEMETH ENGINEERING, INC
1650 WATERMARK DR, STE 200
COLUMBUS, OH 43215 614-487-1650

MECHANICAL ELECTRICAL:
KORDA NEMETH ENGINEERING, INC
1650 WATERMARK DR, STE 200
COLUMBUS, OH 43215 614-487-1650

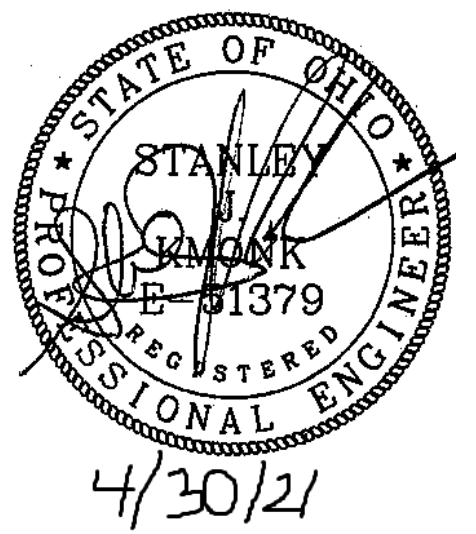

GAHANNA BRANCH LIBRARY

CONSTRUCTION DOCUMENTS

3/9/2022

REVISIONS

MARK	DATE	DESCRIPTION

SCALE 1" = 30'-0"	PROJECT ARCHITECT KNE
PROJECT NUMBER 102327	

TECHNOLOGY SITE PLAN

SHEET NUMBER
T-001

- CODED NOTES
1. CONNECTION TO AEP POLE.
 2. TELECOM SERVICE CONDUITS.



A SITE PLAN
TECHNOLOGY SITE PLAN
SCALE: 1" = 30'-0"

KORDA
KORDA NEMETH ENGINEERING
1650 WATERMARK DRIVE
SUITE 200
COLUMBUS, OHIO 43215

DRAWN BY: Garrett W. Straus
DESIGNED BY: Phaire S. Galina
CHECKED BY: Checker
PROJECT NUMBER: 2021-0529

PLAN NORTH

3/8/2022 11:13:02 AM

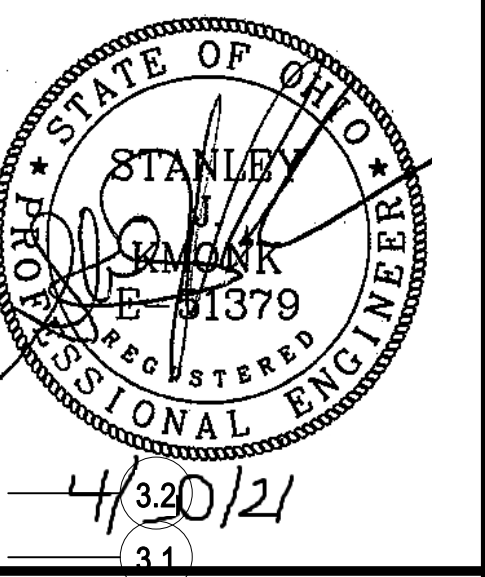

3/9/2022

REVISIONS

MARK	DATE	DESCRIPTION
8	02/11/2022	BULLETIN 06
4	12/08/2021	BULLETIN XX (PRELIMINARY)

SCALE	PROJECT ARCHITECT
1/8" = 1'-0"	KNE
PROJECT NUMBER	102327

SHEET NAME
LEVEL 01 TECHNOLOGY PLAN

SHEET NUMBER
T-201

GENERAL NOTES

- COORDINATE AV FINAL LOCATIONS WITH OWNER AND OWNER'S AV VENDOR.
- THE SPEAKERS LOCATED IN THE MEETING ROOMS SHALL BE CONNECTED BACK TO AV CABINET AND IN IT/DATA ROOM 212.
- THE SPEAKERS LOCATED IN THE PROGRAM SPACE SHALL BE CONNECTED BACK TO AV CABINET AND IN IT/DATA ROOM 212.
- ALL OTHER SPEAKERS ON THE PLAN ARE PART OF THE PAGING SYSTEM.
- LISTEN TECHNOLOGIES HEARING LOOP IN FLOOR OF ALL THREE MEETING ROOMS.

CODED NOTES

- NOT USED.
- DATA OUTLET FOR ROOM SCHEDULE MONITORS(48" AFF). REFER TO DETAIL HJT-701 FOR MOUNTING BOX.
- POE DATA FOR PEOPLE COUNTER, INSTALL ABOVE DOOR.
- 70" TOUCH SCREEN TV INTERACTIVE DISPLAY.
- DOOR POSITION SWITCH ON ROOF HATCH DOOR.
- TWO (2) 3" CONDUITS FOR DATA CABLE.
- LOCATION OF SLEEVES INTO TECH ROOM 2ND FLOOR.
- N/A.
- DA-LITE ADVANTAGE TNSD 133D HD-1.1 PROJECTOR SCREEN.

THIS CONTRACT IS FOR SECURITY ONLY (SEE SYMBOLS LIST T-000). ALL OTHER DEVICES ARE FOR REFERENCE ONLY. CABLING FOR CAMERAS BY STRUCTURED CABLING CONTRACTOR.

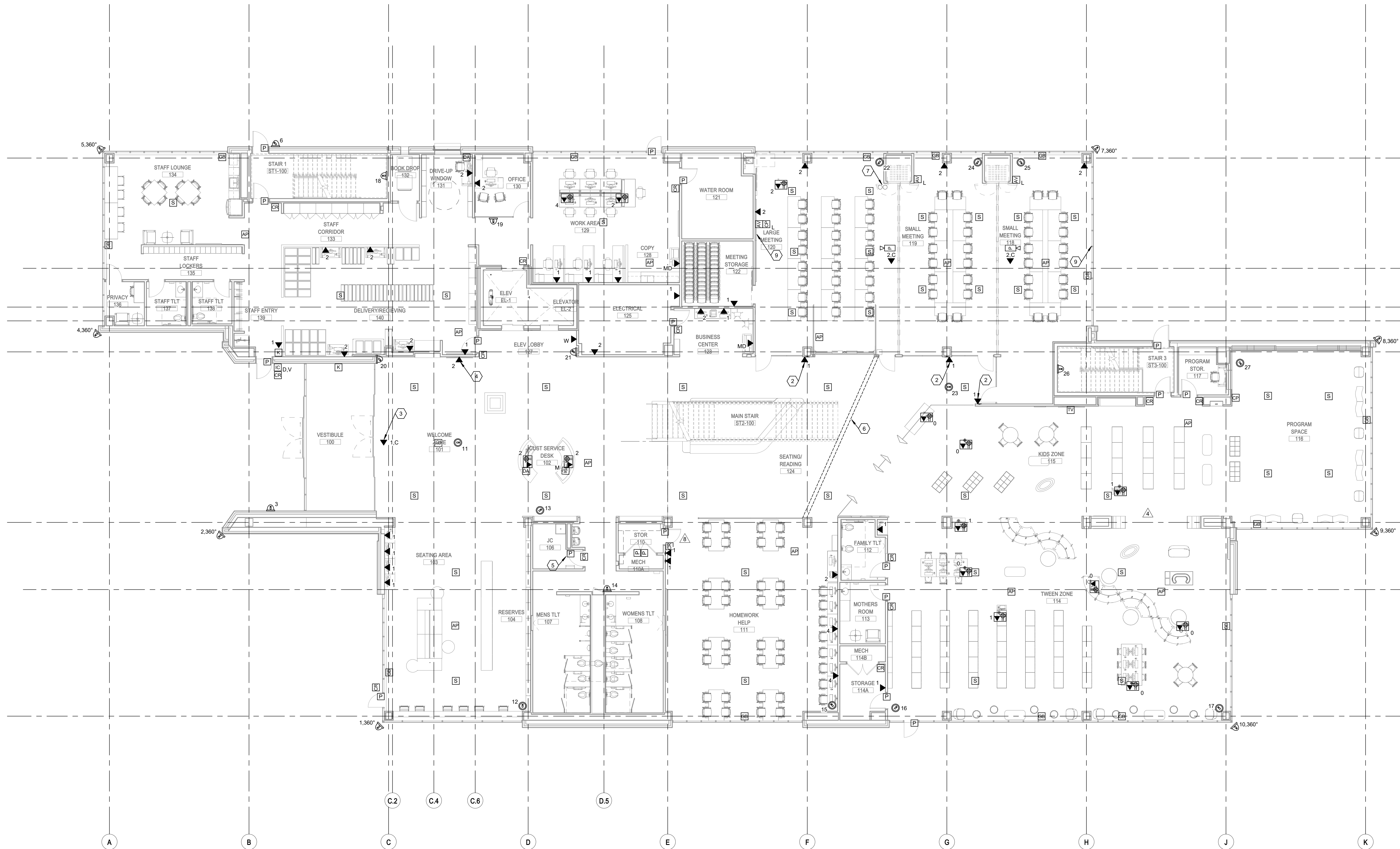

FLOOR PLAN
LEVEL 01 TECHNOLOGY PLAN

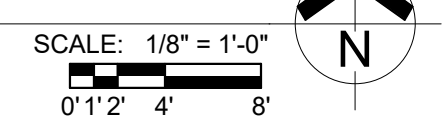

KORDA
KORDA NEMETH ENGINEERING
1650 WATERMARK DRIVE
SUITE 200
COLUMBUS, OHIO 43215
DRAWN BY: Garrett W. Straus
DESIGNED BY: Prate S. Galina
CHECKED BY: Stan Knoch
PROJECT NUMBER: 2021-0529



COLUMBUS METROPOLITAN LIBRARY

CONSTRUCTION MANAGER:
TURNER CONSTRUCTION COMPANY
282 HANOVER ST
COLUMBUS, OH 614-984-3000

STRUCTURAL ENGINEER:
KORDA NEMETH ENGINEERING, INC
1650 WATERMARK DR. STE 200
COLUMBUS, OH 43215 614-467-1650

MECHANICAL ELECTRICAL:
KORDA NEMETH ENGINEERING, INC
1650 WATERMARK DR. STE 200
COLUMBUS, OH 43215 614-467-1650

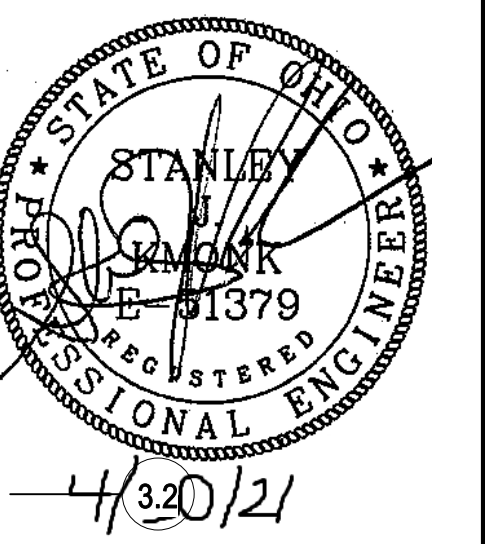

GAHANNA BRANCH LIBRARY

CONSTRUCTION DOCUMENTS

3/9/2022

REVISIONS

MARK	DATE	DESCRIPTION
8	02/11/2022	BULLETIN 06

SCALE	PROJECT ARCHITECT
1/8" = 1'-0"	KNE
PROJECT NUMBER	102327

SHEET NAME
LEVEL 02 TECHNOLOGY PLAN

SHEET NUMBER
T-203

- GENERAL NOTES**
- COORDINATE AV FINAL LOCATIONS WITH OWNER AND OWNER'S AV VENDOR.
- CODED NOTES**
- COORDINATE LOCATION WITH BAS CONTROL PANEL.
 - DUAL LENS CAMERA.
 - TEMPERATURE CONTROL.
 - LIGHTING CONTROL.
 - PROVIDE TWO OUTLETS, WITH 4-DATA IN EACH, IN THE 6-COMPARTMENT LEGRAND RFB6 FLOORBOX.
 - SEE CONFERENCE ROOM OUTLET DETAIL T702.

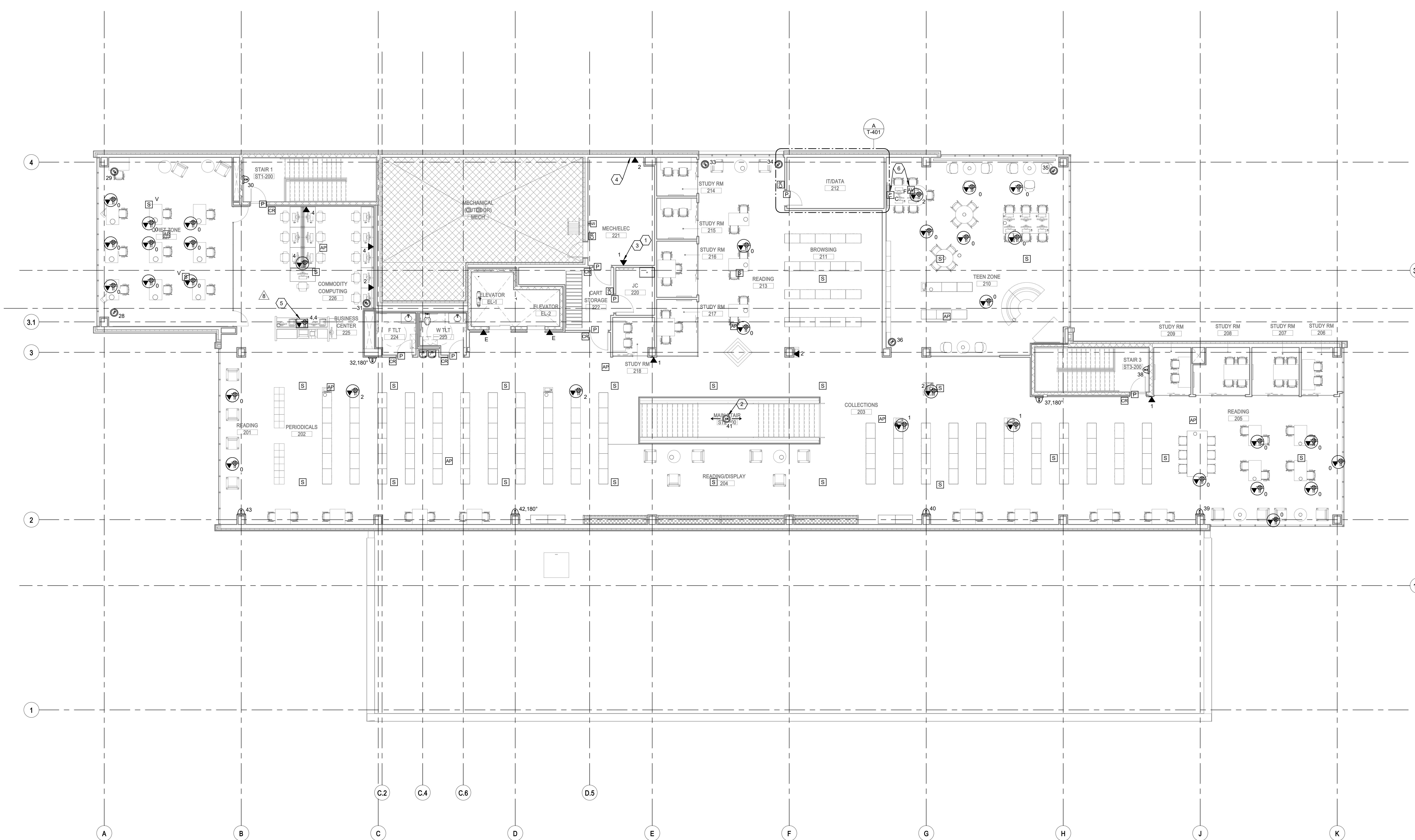

A FLOOR PLAN
LEVEL 02 TECHNOLOGY PLAN

SCALE: 1/8" = 1'-0"
0' 1" 2" 4" 8"

KORDA
KORDA NEMETH ENGINEERING
1650 WATERMARK DRIVE
SUITE 200
COLUMBUS, OHIO 43215

DESIGNED BY: Prate S. Galina
CHECKED BY: Checker
PROJECT NUMBER: 2021-0529

PLAN NORTH

THIS CONTRACT IS FOR SECURITY ONLY (SEE SYMBOLS LIST T-000). ALL OTHER DEVICES ARE FOR REFERENCE ONLY. CABLING FOR CAMERAS BY STRUCTURED CABLING CONTRACTOR.

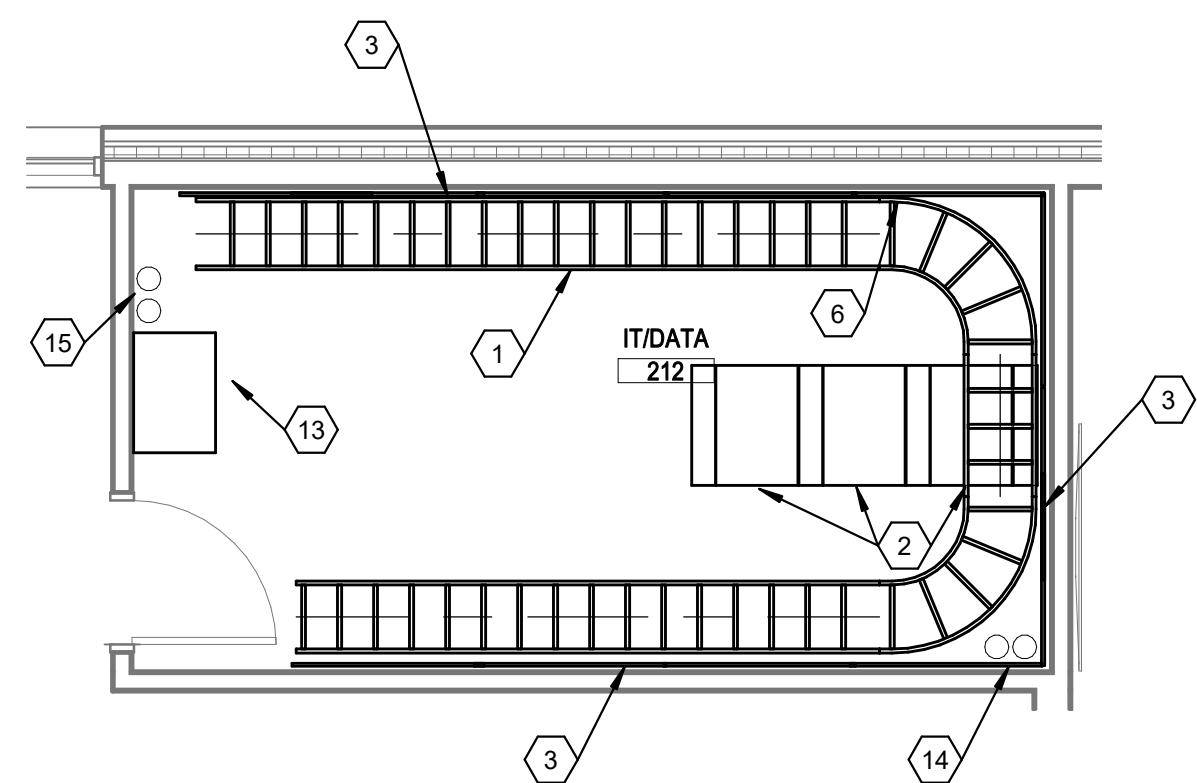

A ENLARGED PLAN
IT / DATA 212

SCALE: 1/4" = 1'-0"
0 1 2 4

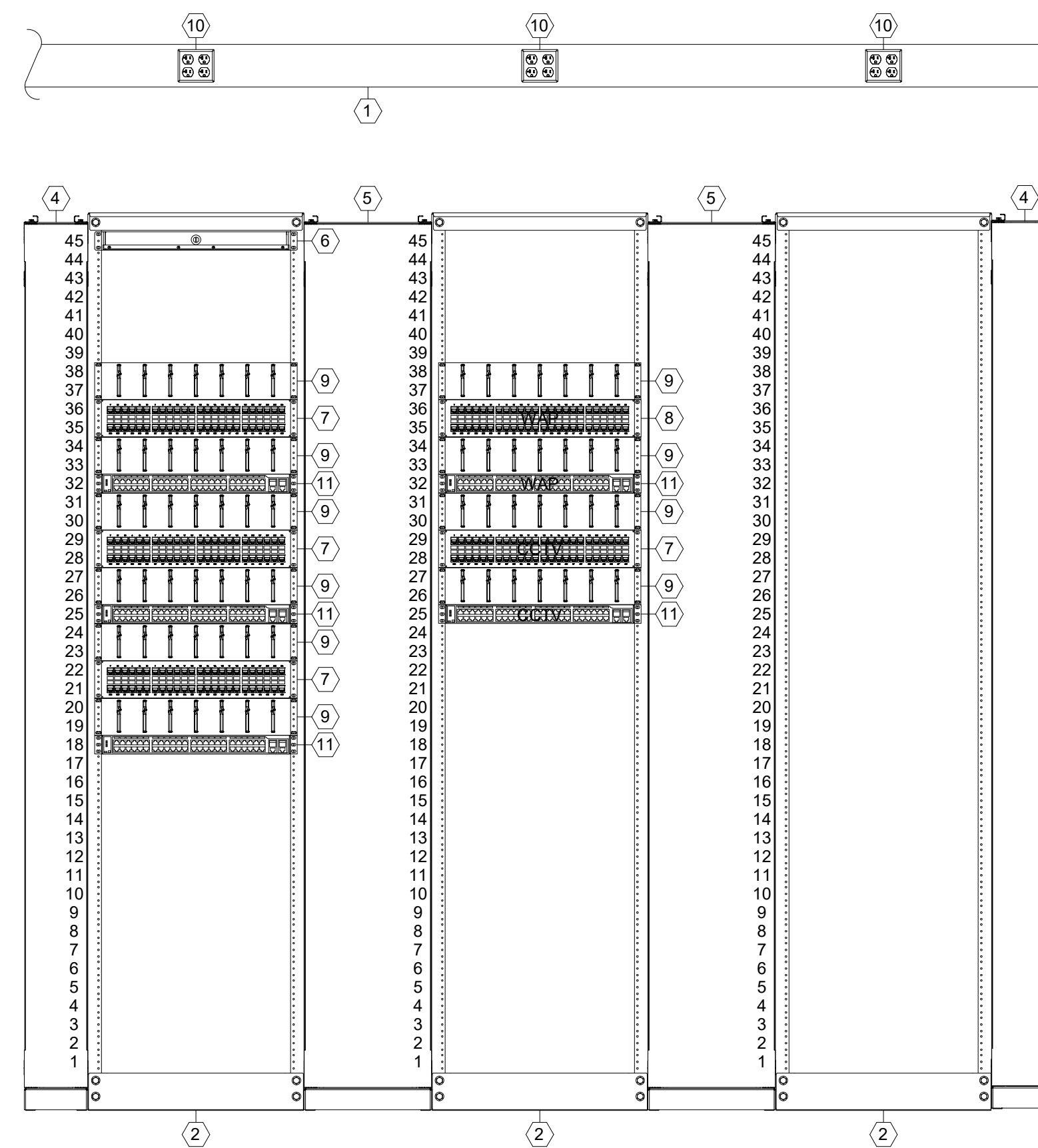

B ELEVATION

NTS

CODED NOTES

1. 18" LADDER RACK.
2. 4-POST EQUIPMENT RACK.
3. PLYWOOD BACKBOARD.
4. 6" WIDE VERTICAL CABLE MANAGEMENT.
5. 8" WIDE VERTICAL CABLE MANAGEMENT.
6. MAIN TECHNOLOGY GROUNDING BUSBAR.
7. 2U 48 PORT CAT-6 PATCH PANEL.
8. 2U 48 PORT CAT-6A PATCH PANEL.
9. 2U HORIZONTAL CABLE MANAGER.
10. SURFACE MOUNTED ELECTRICAL RECEPTACLE AND CONDUIT SHALL BE CLAMPED TO SIDE OF LADDER RACK.
11. NETWORK ELECTRONICS BY OWNER.
12. ACCESS CONTROL PANEL LOCATION.
13. AV EQUIPMENT RACK FOR 1ST FLOOR MEETING ROOMS. INSTALLED BY OWNER AV CONTRACTOR.
14. TWO (2) 4" SLEEVES FROM 1ST FLOOR CEILING FOR COMMUNICATIONS CABLE FROM 1ST FLOOR.
15. TWO (2) CONDUITS FOR INTERNET AND PHONE FROM THE COMMUNICATIONS SUPPLIER (SPECTRUM).

COLUMBUS METROPOLITAN LIBRARY

CONSTRUCTION MANAGER:
TURNER CONSTRUCTION COMPANY
282 HANOVER ST
COLUMBUS, OH 614-884-3000

STRUCTURAL ENGINEER:
KORDA NEMETH ENGINEERING, INC
1650 WATERMARK DR. STE 200
COLUMBUS, OH 43215 614-487-1650

MECHANICAL ELECTRICAL:
KORDA NEMETH ENGINEERING, INC
1650 WATERMARK DR. STE 200
COLUMBUS, OH 43215 614-487-1650

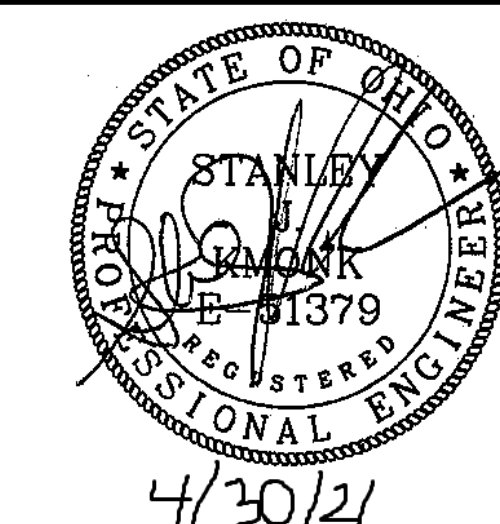

GAHANNA BRANCH LIBRARY

CONSTRUCTION DOCUMENTS

3/9/2022

REVISIONS

MARK	DATE	DESCRIPTION

SCALE: 1/4" = 1'-0" PROJECT ARCHITECT: KNE
PROJECT NUMBER: 102327

TECHNOLOGY ENLARGED PLANS

SHEET NUMBER
T-401

KORDA
KORDA NEMETH ENGINEERING
1650 WATERMARK DRIVE
SUITE 200
COLUMBUS, OHIO 43215
DRAWN BY: Garrett W. Straus
DESIGNED BY: Prate S. Galina
CHECKED BY: Checker
PROJECT NUMBER: 2021-0529



3/8/2022 11:14:01 AM

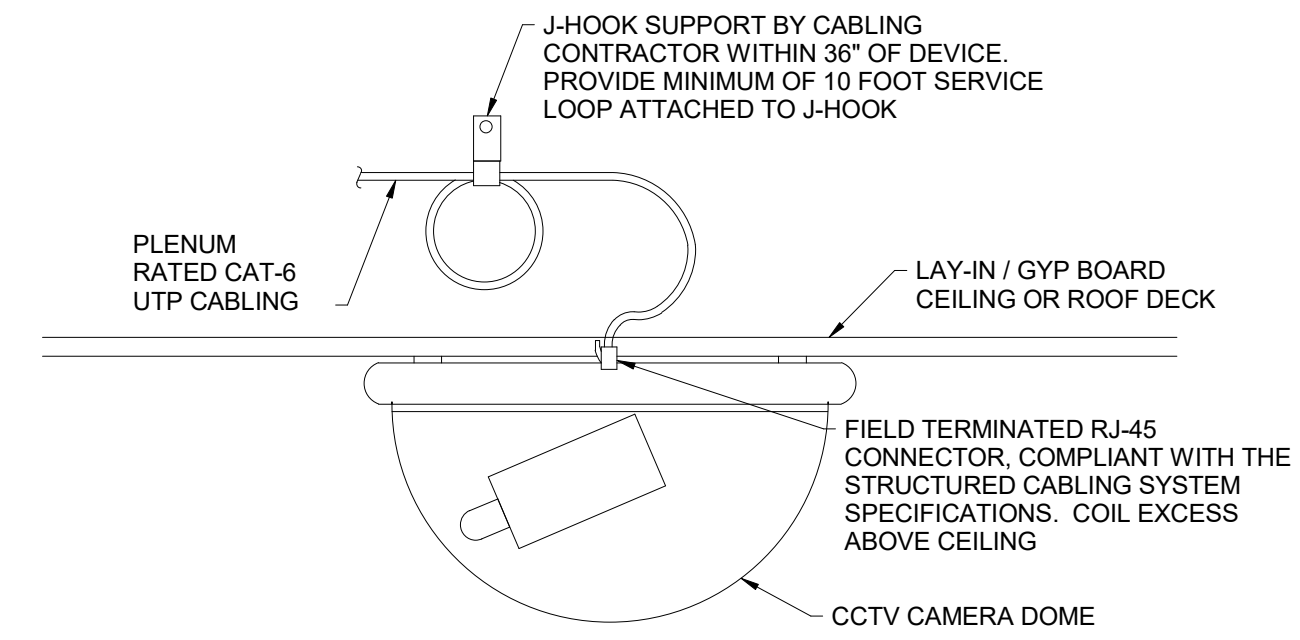

1 DETAIL
CCTV CAMERA - DIRECT ATTACH CONNECTION N.T.S.

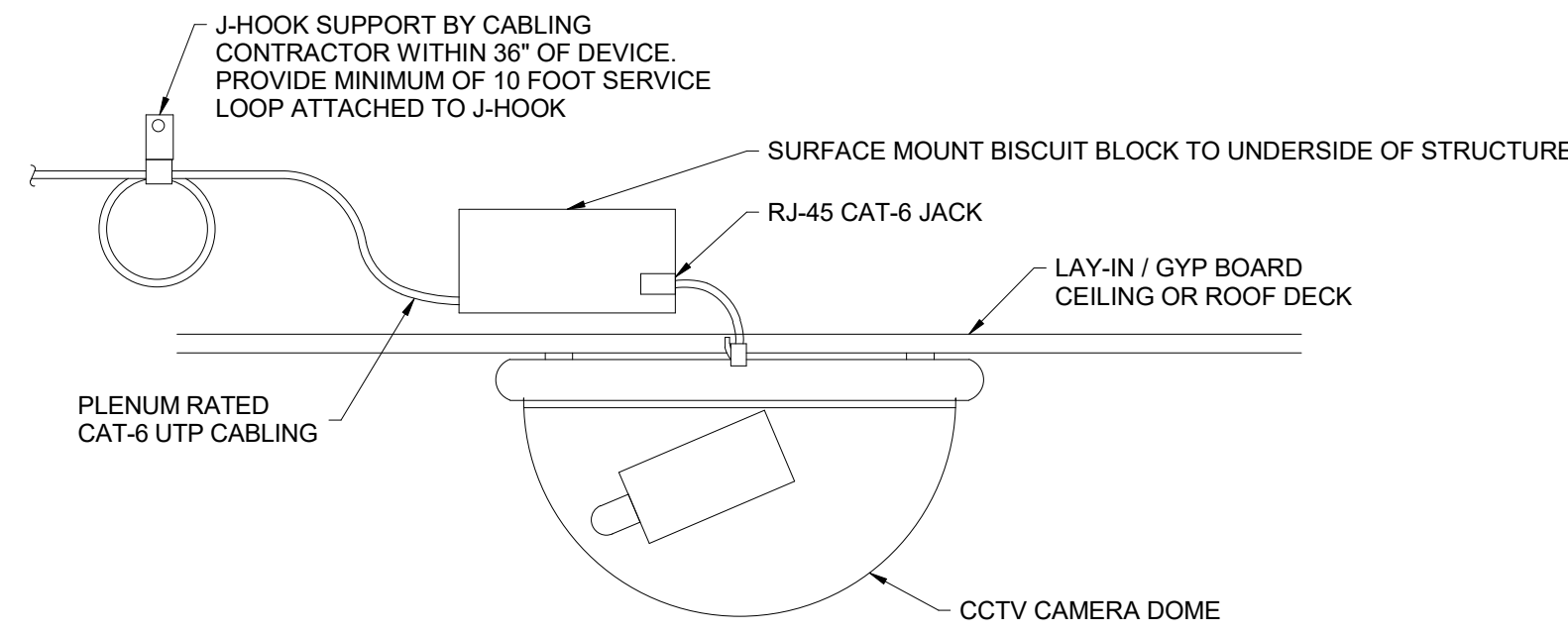

2 DETAIL
CCTV CAMERA - STANDARD CONNECTION N.T.S.

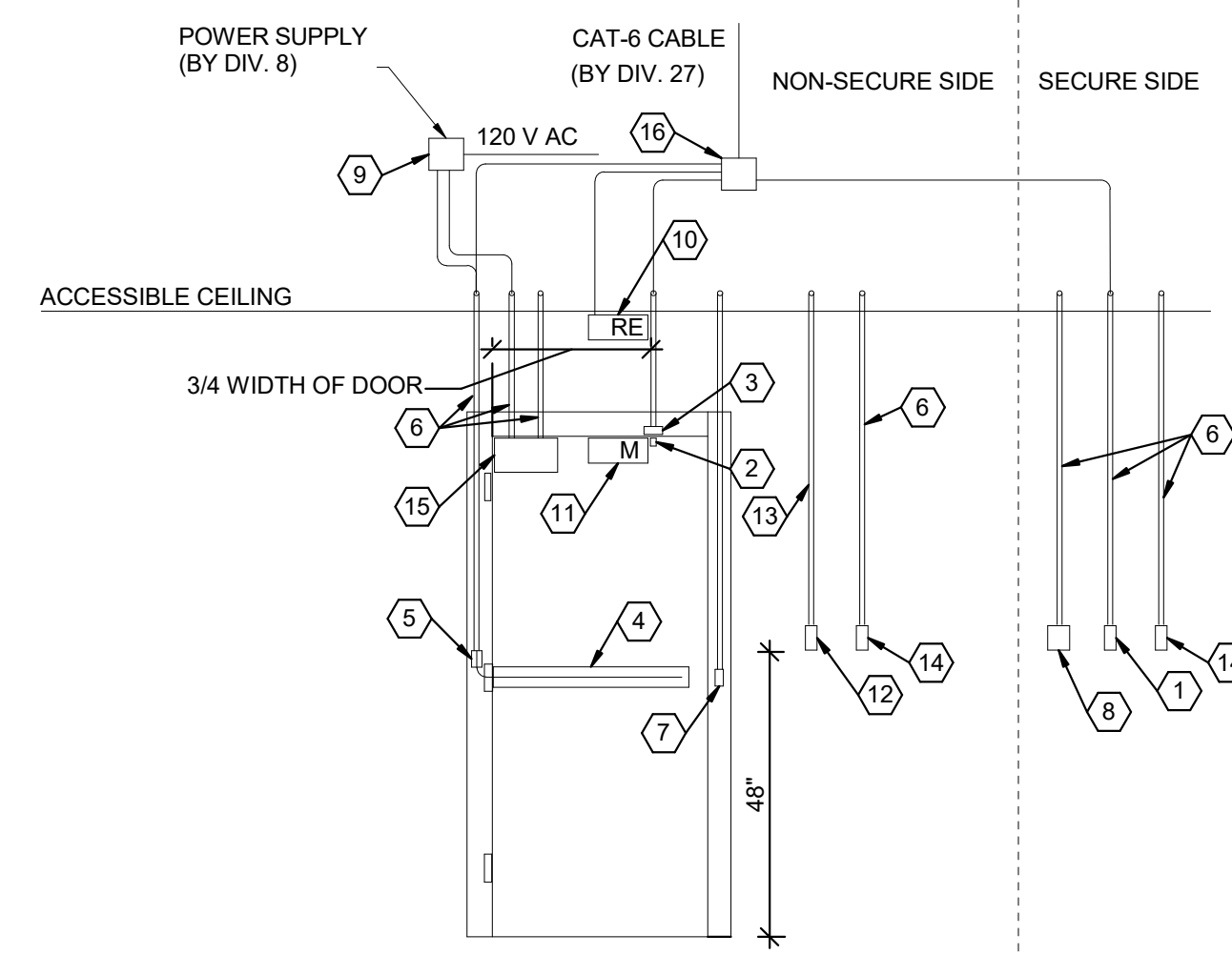

3 DETAIL
SINGLE DOOR SECURITY DEVICE N.T.S.

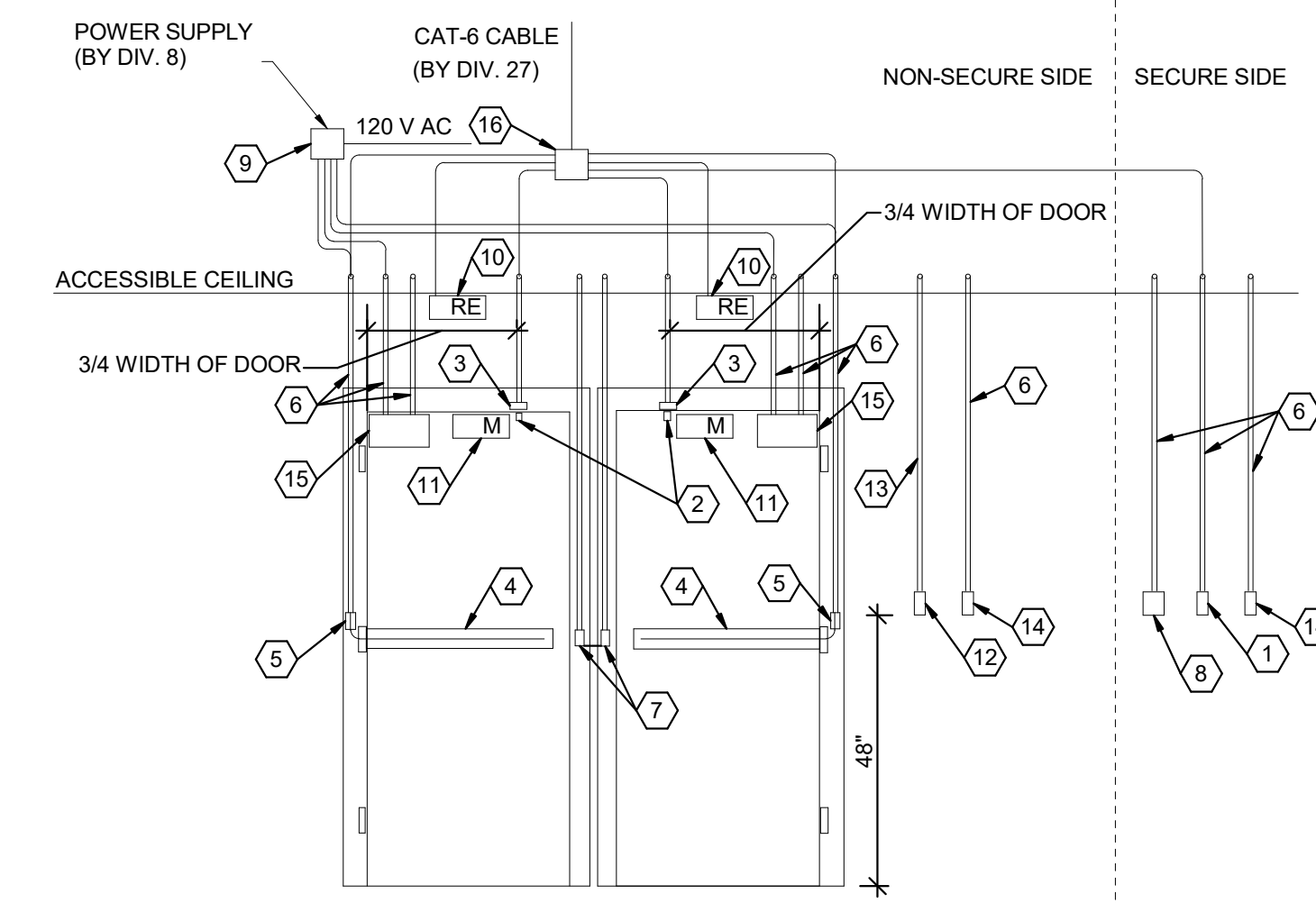

4 DETAIL
DOUBLE DOOR SECURITY DEVICE N.T.S.

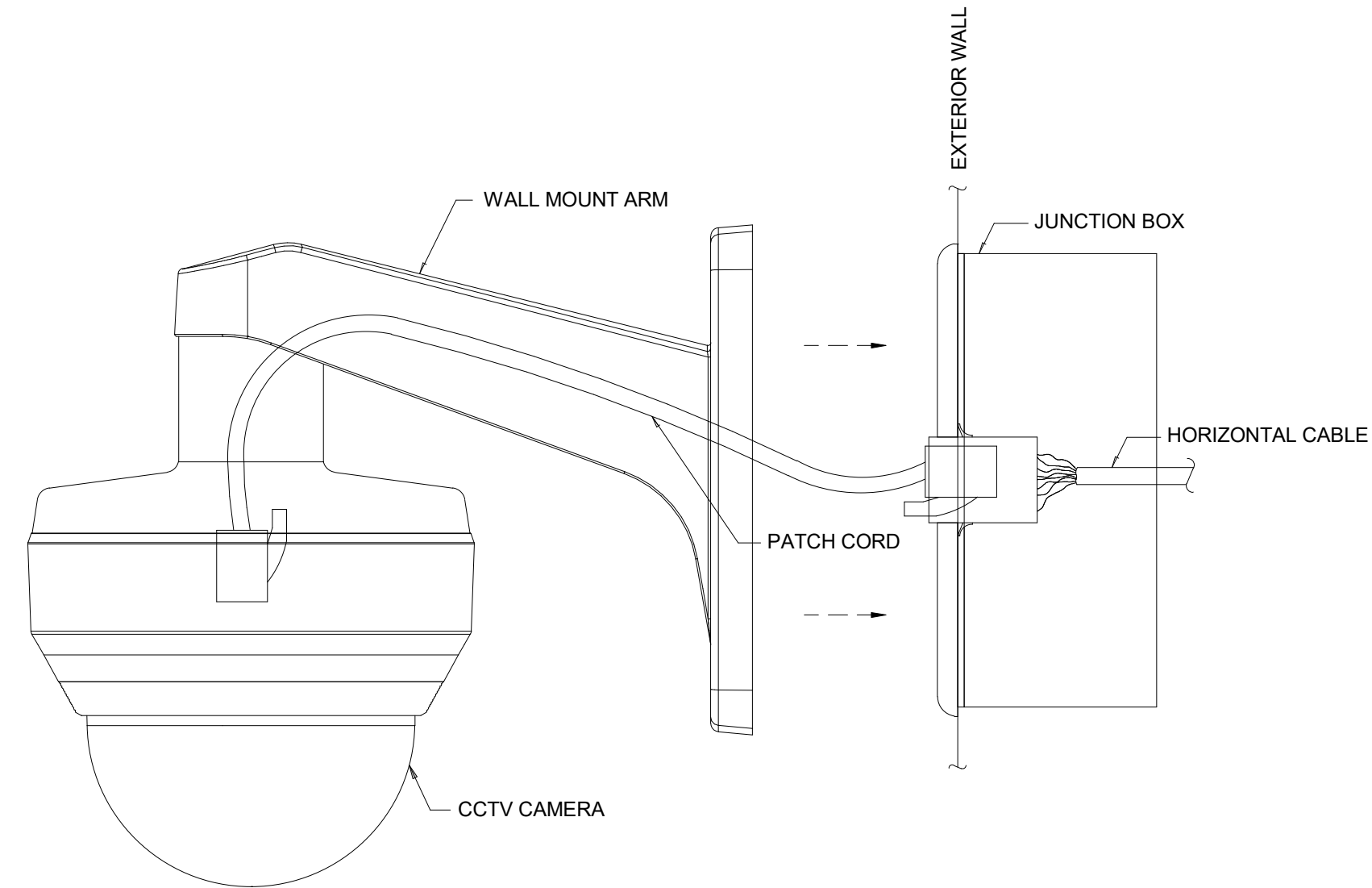

5 DETAIL
EXTERIOR CCTV CAMERA - STANDARD CONNECTION N.T.S.

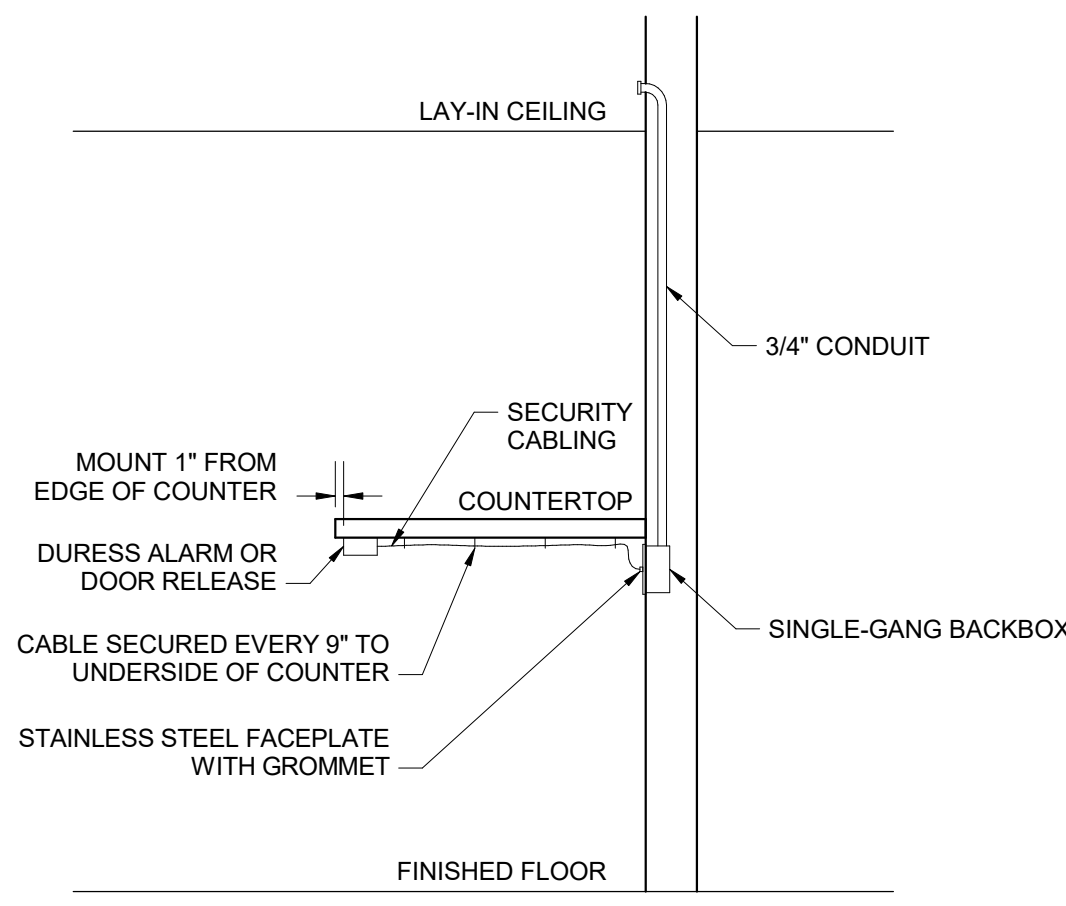

6 DETAIL
DURESS ALARM / DOOR RELEASE N.T.S.

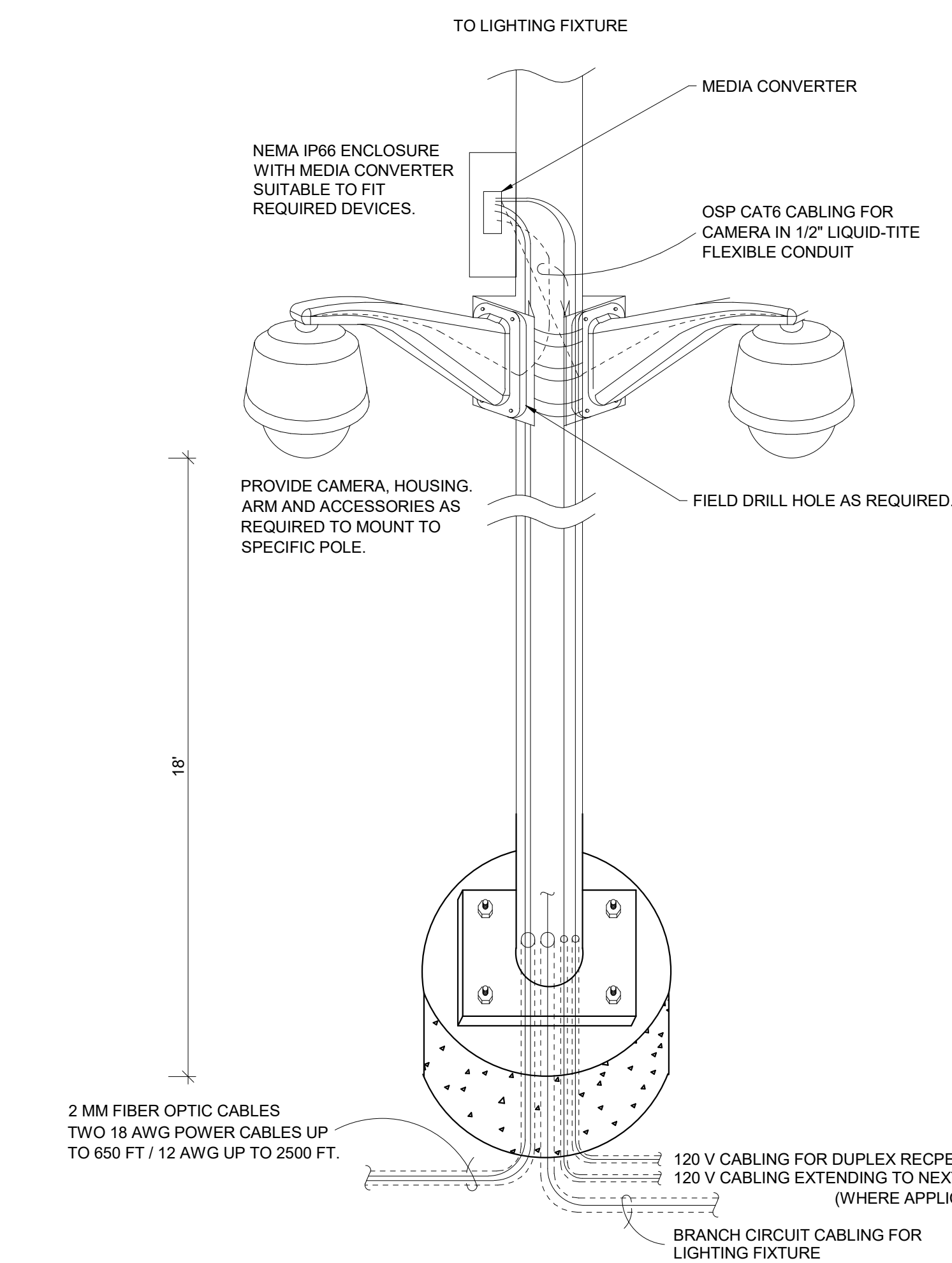

7 DETAIL
POLE MOUNTED CAMERA WITHOUT BASE N.T.S.

- NOTES**
- POLES, CONDUIT, AND NEMA ENCLOSURE BOX ARE THE RESPONSIBILITY OF THE DIVISION 26 CONTRACTOR.
 - NETWORK CABLE IS THE RESPONSIBILITY OF THE DIVISION 27 CONTRACTOR.
 - ALL LINE VOLTAGE POWER IS THE RESPONSIBILITY OF THE DIVISION 26 CONTRACTOR. ALL LOW VOLTAGE POWER IS THE RESPONSIBILITY OF THE DIVISION 27 CONTRACTOR.
 - CAMERA AND EITHER ETHERNET EXTENDER OR MEDIA CONVERTOR ARE THE RESPONSIBILITY OF THE DIVISION 28 CONTRACTOR.
 - CAMERA HOUSING SHALL BE PAINTED TO MATCH POLE.

GENERAL NOTES

- EACH DOOR DOES NOT CONTAIN EACH DEVICE DEPICTED. SEE DOOR HARDWARE SCHEDULE AND FLOOR PLANS FOR MORE INFORMATION.

CODED NOTES

- CARD READER BY DIV. 28. BACKBOX BY DIV. 26.
- DOOR CONTACT BY DIV. 28.
- BACKBOX AND 3/4" CONDUIT FROM BACKBOX TO ABOVE ACCESSIBLE CEILING BY DIV. 26. UTILIZE FOR DOOR CONTACT (AND MAG LOCK IF APPLICABLE).
- ELECTRIC CRASH BAR (IF APPLICABLE) INSTALLED BY DIV. 8 AND WIRED TO POWER SUPPLY BY DIV. 28.
- BACKBOX MOUNTED IN DOOR FRAME (IF ELECTRIC CRASH BAR UTILIZED) BY DIV. 26.
- 3/4" CONDUIT FROM BACKBOX TO ABOVE CEILING (IF DEVICE UTILIZED) BY DIV. 26.
- BACKBOX AND 3/4" CONDUIT FROM TO ABOVE ACCESSIBLE CEILING FOR DOOR STRIKE (IF APPLICABLE) BY DIV. 26.
- KEYPAD BY DIV. 28. 4-SQUARE MASONRY BACKBOX BY DIV. 26.
- POWER SUPPLY INSTALLED AND WIRED TO 120 V AC BY DIV. 26.
- REQUEST TO EXIT MOTION DETECTOR (IF APPLICABLE) BY DIV. 28. MOUNT TO CEILING CENTERED ABOVE DOORWAY WHENEVER POSSIBLE. IF CEILING MOUNT IS NOT POSSIBLE WALL MOUNT WITH A SINGLE GANG BOX AT 108" AND EXTEND A 3/4" CONDUIT TO ABOVE ACCESSIBLE CEILING BY DIV. 26.
- MAGNETIC DOOR LOCK (IF APPLICABLE) BY DIV. 8. UTILIZE SAME CONDUIT AS DOOR CONTACT. PROVIDE FIRE ALARM TIE IN TO RELEASE MAG LOCK UPON ACTIVATION OF FIRE ALARM.
- REQUEST TO EXIT BUTTON (IF APPLICABLE) BY DIV. 28. SINGLE GANG MASONRY BACKBOX (IF APPLICABLE) BY DIV. 26.
- 3/4" CONDUIT FROM BACKBOX TO ABOVE ACCESSIBLE CEILING (IF MAG LOCK UTILIZED) BY DIV. 26.
- WALL ACTUATOR STATION FOR DOOR OPERATOR BY DIV. 8. SINGLE GANG MASONRY BACKBOX BY DIV. 26.
- POWER OPERATED DOOR OPERATOR (IF WALL ACTIVATOR UTILIZED) BY DIV. 8.
- DOOR CONTROLLER BY DIV. 28.

GENERAL NOTES

- EACH DOOR DOES NOT CONTAIN EACH DEVICE DEPICTED. SEE DOOR HARDWARE SCHEDULE AND FLOOR PLANS FOR MORE INFORMATION.

CODED NOTES

- CARD READER BY DIV. 28. BACKBOX BY DIV. 26.
- DOOR CONTACT BY DIV. 28.
- BACKBOX AND 3/4" CONDUIT FROM BACKBOX TO ABOVE ACCESSIBLE CEILING BY DIV. 26. UTILIZE FOR DOOR CONTACT (AND MAG LOCK IF APPLICABLE).
- ELECTRIC CRASH BAR (IF APPLICABLE) INSTALLED BY DIV. 8 AND WIRED TO POWER SUPPLY BY DIV. 28.
- BACKBOX MOUNTED IN DOOR FRAME (IF ELECTRIC CRASH BAR UTILIZED) BY DIV. 26.
- 3/4" CONDUIT FROM BACKBOX TO ABOVE CEILING (IF DEVICE UTILIZED) BY DIV. 26.
- BACKBOX AND 3/4" CONDUIT FROM TO ABOVE ACCESSIBLE CEILING FOR DOOR STRIKE (IF APPLICABLE) BY DIV. 26.
- KEYPAD BY DIV. 28. 4-SQUARE MASONRY BACKBOX BY DIV. 26.
- POWER SUPPLY INSTALLED AND WIRED TO 120 V AC BY DIV. 26.
- REQUEST TO EXIT MOTION DETECTOR (IF APPLICABLE) BY DIV. 28. MOUNT TO CEILING CENTERED ABOVE DOORWAY WHENEVER POSSIBLE. IF CEILING MOUNT IS NOT POSSIBLE WALL MOUNT WITH A SINGLE GANG BOX AT 108" AND EXTEND A 3/4" CONDUIT TO ABOVE ACCESSIBLE CEILING BY DIV. 26.
- MAGNETIC DOOR LOCK (IF APPLICABLE) BY DIV. 8. UTILIZE SAME CONDUIT AS DOOR CONTACT. PROVIDE FIRE ALARM TIE IN TO RELEASE MAG LOCK UPON ACTIVATION OF FIRE ALARM.
- REQUEST TO EXIT BUTTON (IF APPLICABLE) BY DIV. 28. SINGLE GANG MASONRY BACKBOX (IF APPLICABLE) BY DIV. 26.
- 3/4" CONDUIT FROM BACKBOX TO ABOVE ACCESSIBLE CEILING (IF MAG LOCK UTILIZED) BY DIV. 26.
- WALL ACTUATOR STATION FOR DOOR OPERATOR BY DIV. 8. SINGLE GANG MASONRY BACKBOX BY DIV. 26.
- POWER OPERATED DOOR OPERATOR (IF WALL ACTIVATOR UTILIZED) BY DIV. 8.
- DOOR CONTROLLER BY DIV. 28.

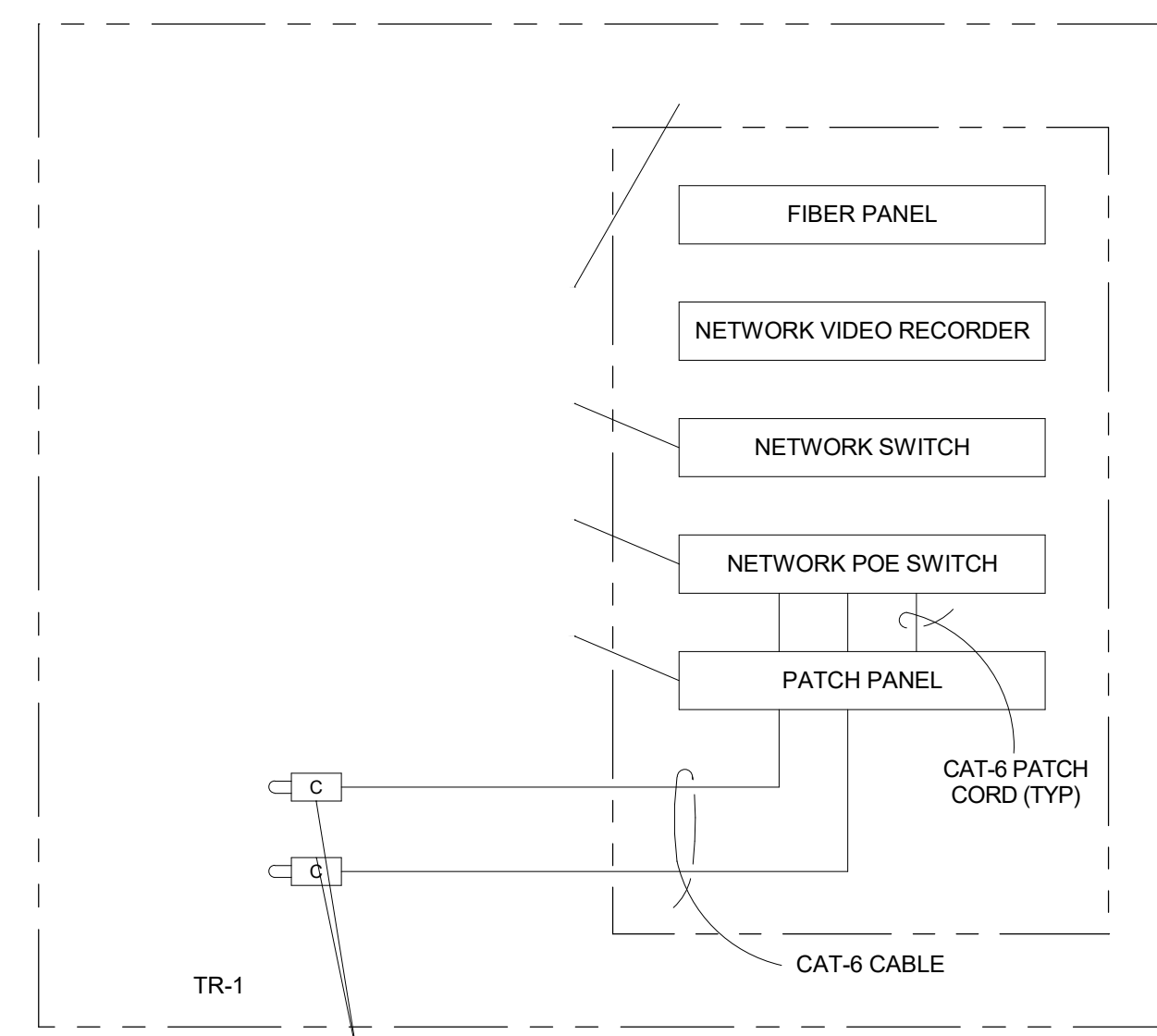

8 DIAGRAM
IP VIDEO SURVEILLANCE RISER N.T.S.

NOTES

- CONTRACTOR SHALL VERIFY CABLING REQUIREMENTS PRIOR TO INSTALLATION.
- DIAGRAM IS FOR REFERENCE ONLY. CONTRACTOR SHALL SUBMIT FOR APPROVAL A SPECIFIC DIAGRAM.
- CONTRACTOR SHALL COORDINATE EXACT POWER SUPPLY CONNECTIONS AND CIRCUIT TO UPS.
- CONTRACTOR SHALL SUPPLY ALL PATCH CABLES AND INTERCONNECTIONS OF THE SYSTEM COMPLY WITH SECTION 27 10 00 FOR CABLING.

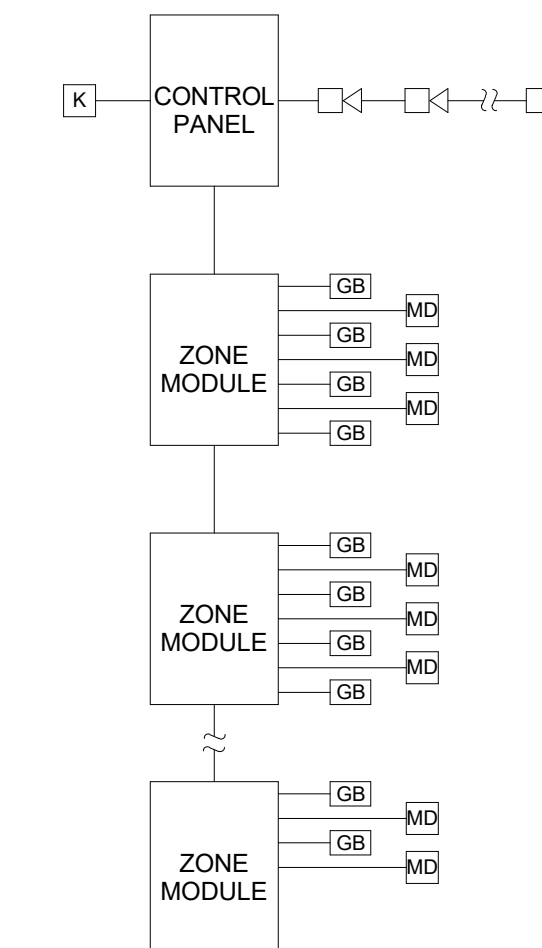

9 DIAGRAM
INTRUSION DETECTION RISER N.T.S.

GENERAL NOTES

- THIS DIAGRAM IS TYPICAL IN NATURE. PLEASE REFER TO ACTUAL SECURITY SYSTEM SUBMITTAL FOR ACTUAL INSTALLATION DETAILS.
- ALL DEVICES WILL BE PROVIDED IN THE DIVISION 28 SECURITY CONTRACT. CABLING AND CONDUIT PROVIDED BY THE DIVISION 26 ELECTRICAL CONTRACTOR.
- PROVIDE PLENUM RATED CABLE IN ENCLOSED DROP CEILING IN J HOOKS AND ALL EXPOSED CEILING AREAS REQUIRE CONDUIT FROM ABOVE CABLE TRAY TO DEVICE BOX.
- PROVIDE 18 AWG FOUR (4) CONDUCTOR UNSHIELDED CABLE TO FROM HEAD END ON WALL IN MTR TO ZONE MODULES AND FROM ZONE MODULES TO DEVICES. PROVIDE AT LEAST TWO (2) FEET OF SLACK AT EACH LOCATION. TRY TO GROUP DEVICES IN QUANTITIES OF FOUR (4) OR EIGHT (8) DEVICES PER MODULE. LIMIT RUNS TO 100' MAX.
- PROVIDE 18 AWG PAIR IN A LOOP FROM HEAD END MOUNTED ON WALL TO ALL HORNS

COLUMBUS METROPOLITAN LIBRARY

CONSTRUCTION MANAGER:
TURNER CONSTRUCTION COMPANY
262 HANOVER ST
COLUMBUS, OH 614-984-3000

STRUCTURAL ENGINEER:
KORDA/ NEMETH ENGINEERING, INC
1650 WATERMARK DR. STE 200
COLUMBUS, OH 43215-614-487-1650

MECHANICAL/ELECTRICAL:
KORDA/ NEMETH ENGINEERING, INC
1650 WATERMARK DR. STE 200
COLUMBUS, OH 43215-614-487-1650

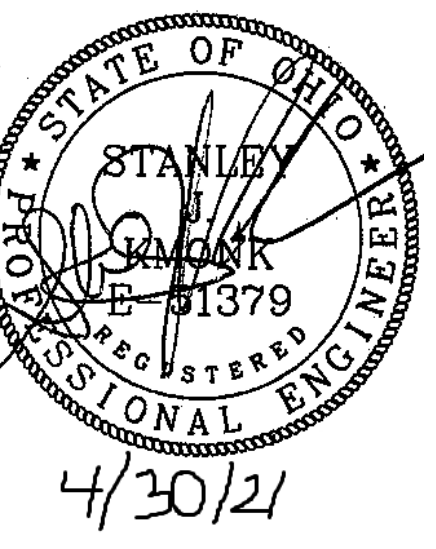

GAHANNA BRANCH LIBRARY

CONSTRUCTION DOCUMENTS

3/9/2022

REVISIONS

MARK	DATE	DESCRIPTION

SCALE	PROJECT ARCHITECT
	KNE

PROJECT NUMBER
102327

TECHNOLOGY DETAILS

SHEET NAME
T-702

SHEET NUMBER
T-702

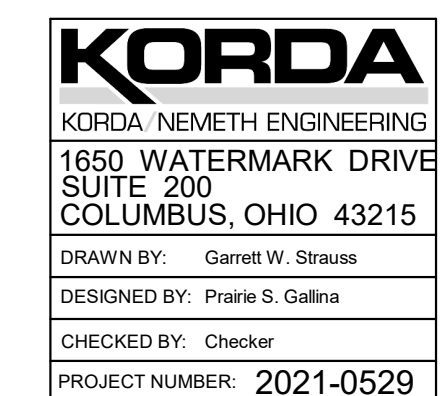

PLAN NORTH

