

REF. FEATURE LEGEND (UNLESS OTHERWISE SPECIFIED) (SEE ORDER ACKNOWLEDGEMENT FOR FINAL SPECIFICATION)	
FEATURE	SELECTION
SPECIES	MAPLE
WOOD FINISH	CWF 18-125
LAMINATE	N/A
SOLID SURFACE	N/A
MARMOLEUM	N/A
HARDWARE FINISH	STD. BLACK
POWDER COAT	N/A
FABRIC	N/A
ELC. FINISH	N/A
RESIN DETAIL	BY OTHERS
OTHER	N/A

FOR APPROVAL

APPROVED
 APPROVED AS NOTED
 REVISE AND RESUBMIT

DRAWING PACKAGE MUST BE RETURNED TO THE WORDEN GROUP WITH APPROPRIATE BOX CHECKED. ADD COMMENTS AND MARK-UPS ON THIS DRAWING PACKAGE (AS NEEDED) (CHECK ONE BOX ONLY)
 NOTE: ANY DIMENSIONAL CHANGES WILL REQUIRE A REVISE AND RESUBMIT STATUS REGARDLESS OF WHICH BOX IS CHECKED.
 SIGNED BY: _____ DATE: _____

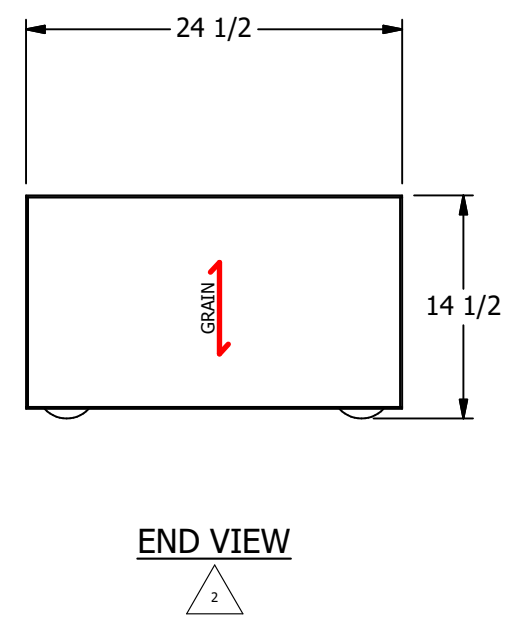
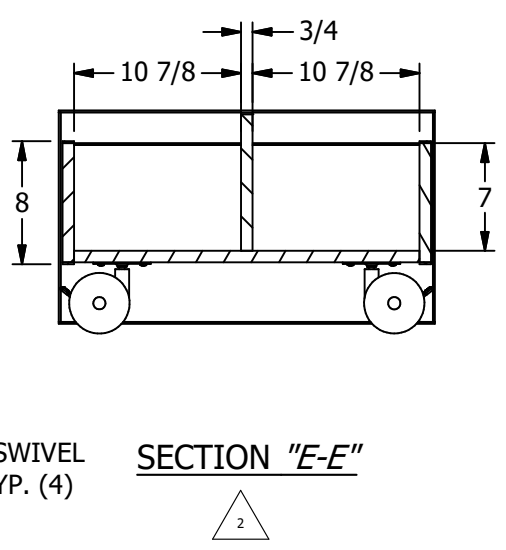
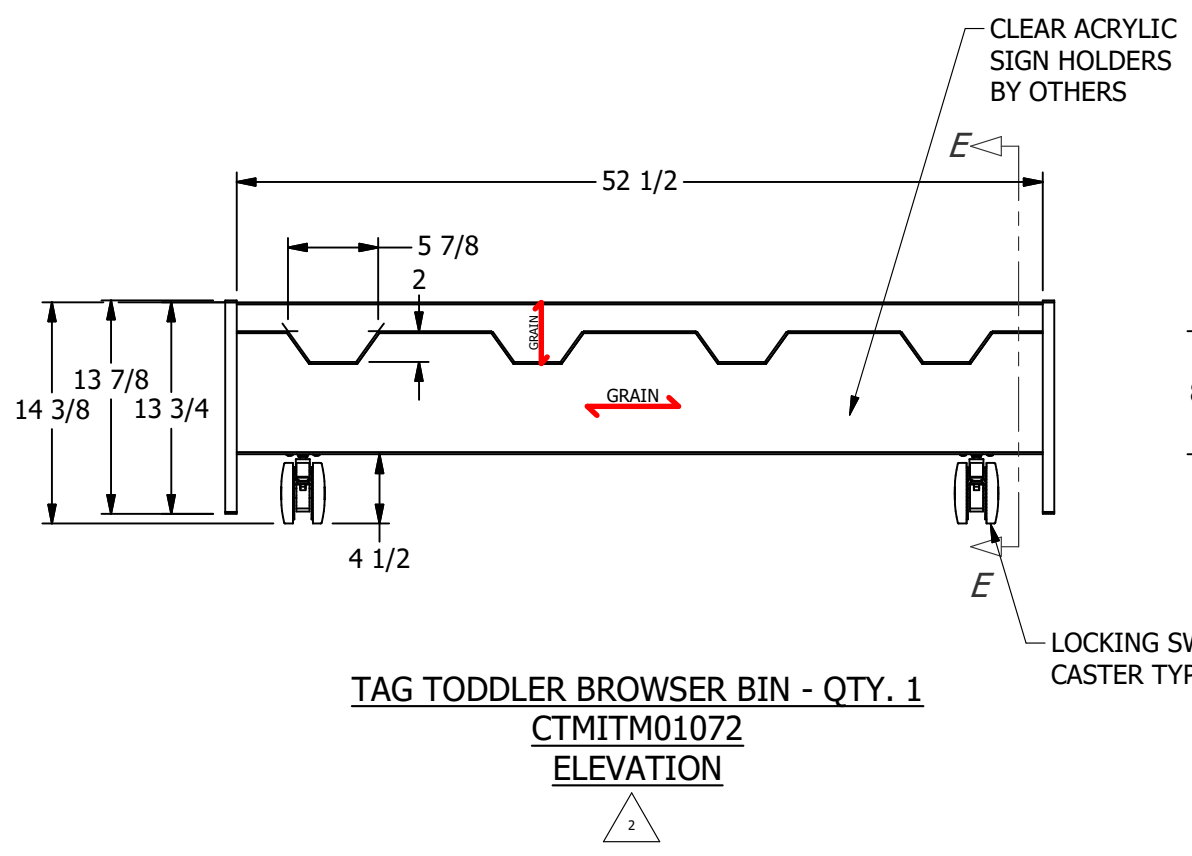
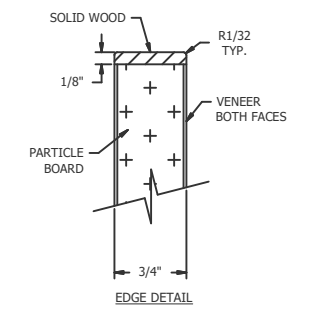
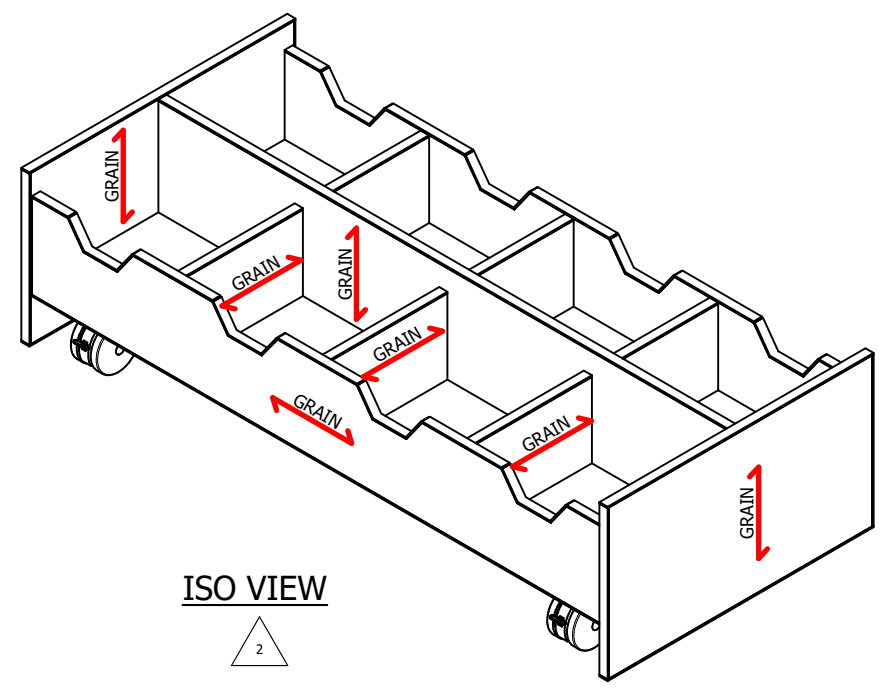
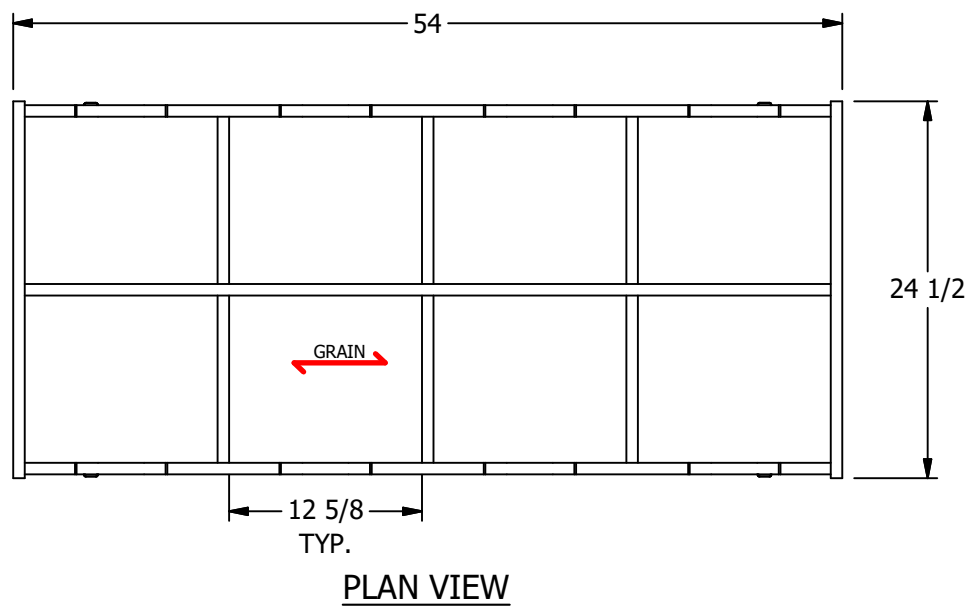

DEALER	Library Design Associates, Inc. (OH)		
PROJECT	Gahanna Library - Technical Furniture		
DRAWING FILE	E3896-APPS.idw		
C:\Worden Working Folder\Designs\Worden\Estimates\E03000 - E03999\E3896\04 IDW\E3896-APPS.idw			
ENGINEERED BY	DATE	DIMENSIONS & TOLERANCES UNLESS OTHERWISE SPECIFIED	
tsall	9/30/2022	.X±.060 .XX±.030 .XXX±.015 ANGLES±0.5° FRACTIONS±1/16 (DIMENSIONS: INCHES)	
THE INFORMATION CONTAINED HEREIN IS CLASSIFIED "CONFIDENTIAL". IT IS THE SOLE PROPERTY OF THE WORDEN GROUP, AND ANY USE THEREOF AND/OR REPRODUCTION THEREOF IS EXPRESSLY PROHIBITED WITHOUT THE WRITTEN CONSENT OF THE WORDEN GROUP.			
THE WORDEN GROUP WORDEN SNAP!OFFICE ECHO		WWW.WORDENCOMPANY.COM 199 EAST 17TH STREET HOLLAND, MI 49423	
ORDER NUMBER	SHEET	REV.	
E3896-APPS	3 OF 6	2	